



- 1 Go to, <https://4h.zsuite.org>



Email  
cleaver@noemail.com

Password  
\*\*\*\*\*

**LOGIN**

SIGN UP

[Forgot Password?](#) [Need Help? Click here](#)

**Enter the email and password for your Household account.**

- 2 Choose an Adult or the Household profile (Youth profiles can't enroll)



**Household**

Primary

CHOOSE PROFILE



**Theodore**

Club Member(Enrollment Status: Pending Approval)

CHOOSE PROFILE

**Select an Adult or the Household profile**

3 Adult and Household profiles require a PIN

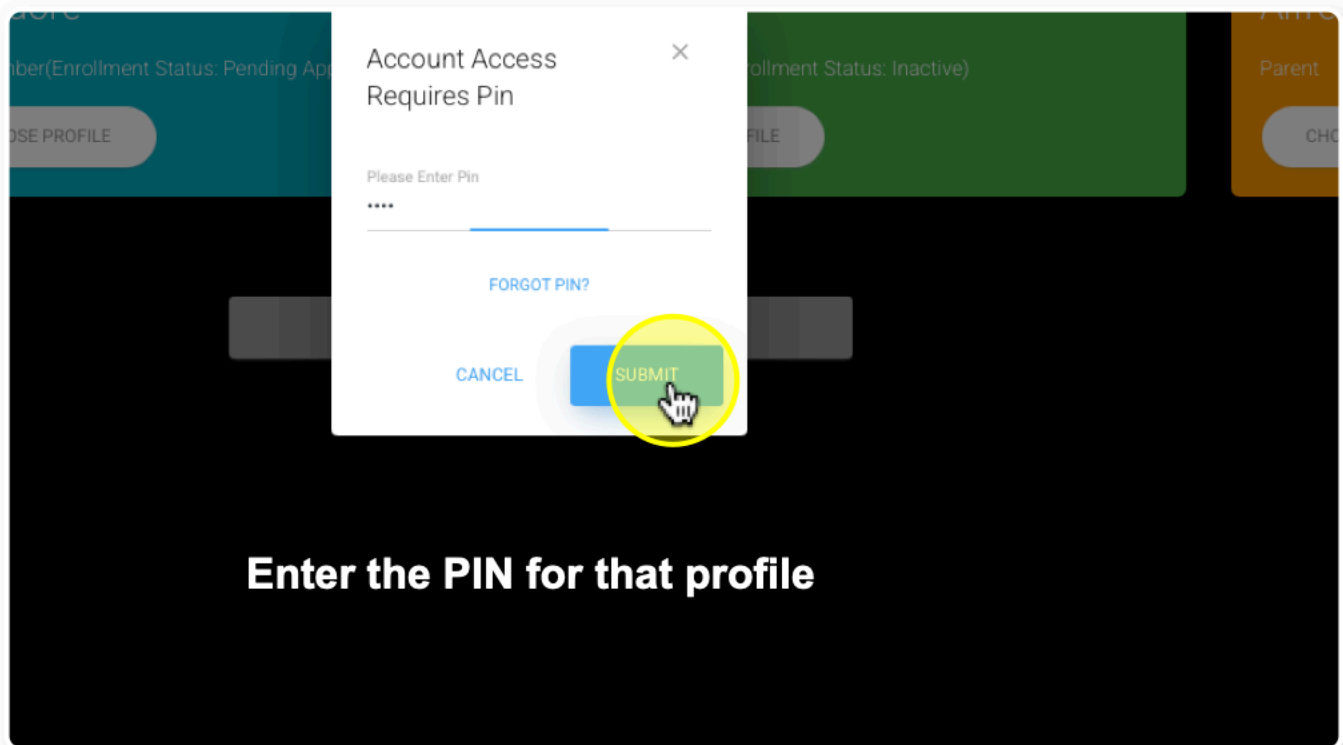

4 Click on the blue button next to the member you want to reenroll.

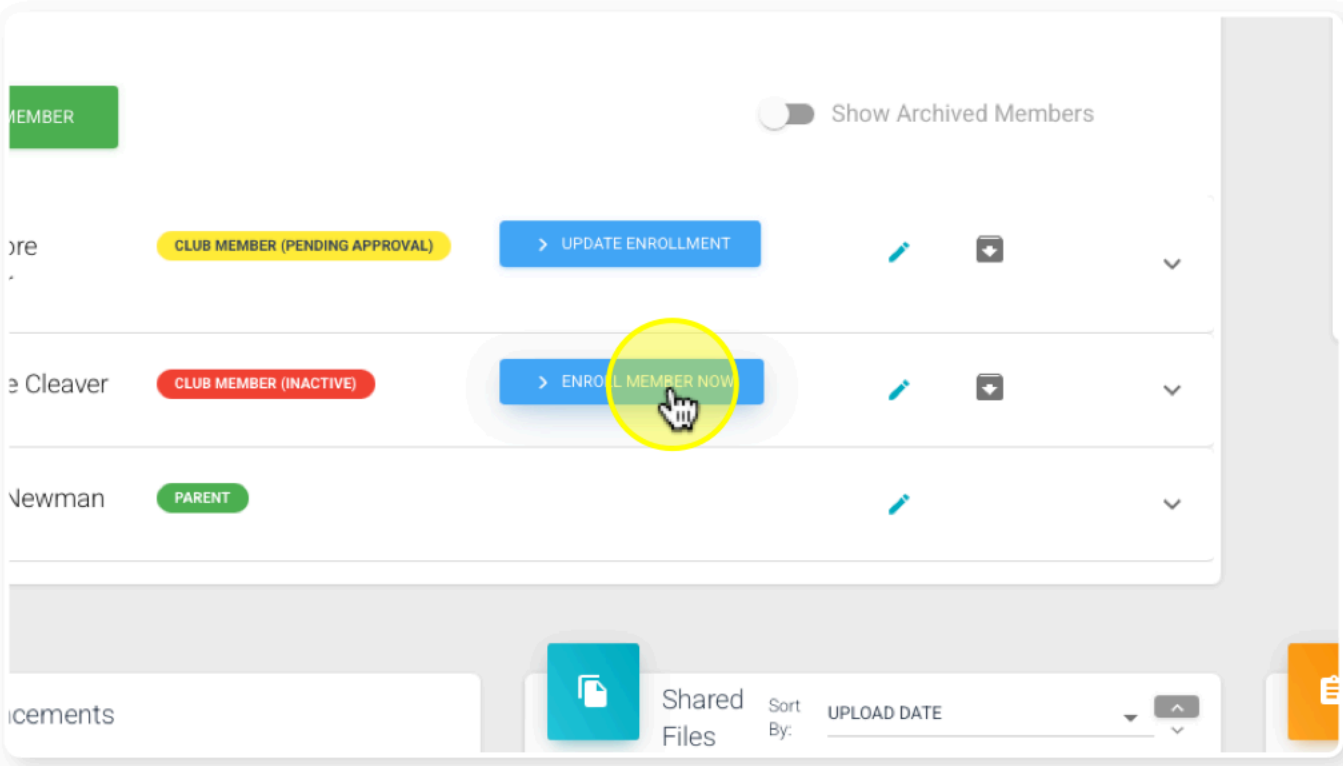

## 5 Personal Information Section

who r... X ▾

Branch of Service  
Coast Guard X ▾

X ▾

irt size ▾

BACK TO DASHBOARD

SAVE FOR LATER

NEXT

**Review Personal Information and update as needed.**

**If your phone number or email has changed, please update.**

**Click Next at the bottom of the page to advance to Waivers.**

© 2025 ZSuite Stay Amazing! the ZSuite Team

## 6 Waivers Section-Update each waiver

**Review and update ALL Waiver agreements.**

**Scroll down as you complete each waiver.**

**Enter Parent Name for each waiver.**

List any other dietary Issues the 4-H member may experience

Waiver Signatures and Approval

The health information provided here is accurate. I understand this information will be used for program planning purposes only

Member Name \*  
sdfdf

\*  
Yes, I agree X ▾

Parent Name \*

Waiver Signature Date  
05/29/2025

4-H Media Release

- 7 Click on "NEXT" at the bottom of the page to advance to the Clubs Section

ion Release 

o use the submitted photograph for educational, promotional, advertising, or  
t the mission of the university.

ion? \*  
a co... X ▾

BACK TO DASHBOARD SAVE FOR LATER **NEXT**

When done with ALL waivers, click Next on the bottom right of the page to advance to Clubs.

- 8 Clubs Section

Review the 4-H clubs listed and add or remove them.

Be sure to include a project associated with each club.

PERSONAL INFO WAIVERS

Click the Add Club button to add one or more Clubs  
*Click on a club to view projects*

**+ ADD CLUB**

**Bashful Bovines Dairy Club** Primary MEMBER

County: Example

**Club Description:**

A 4-H dairy club focused on making the best better. This club is open to youth in year out of college)

- 9 When all your clubs and projects are selected, click on "SUBMIT"

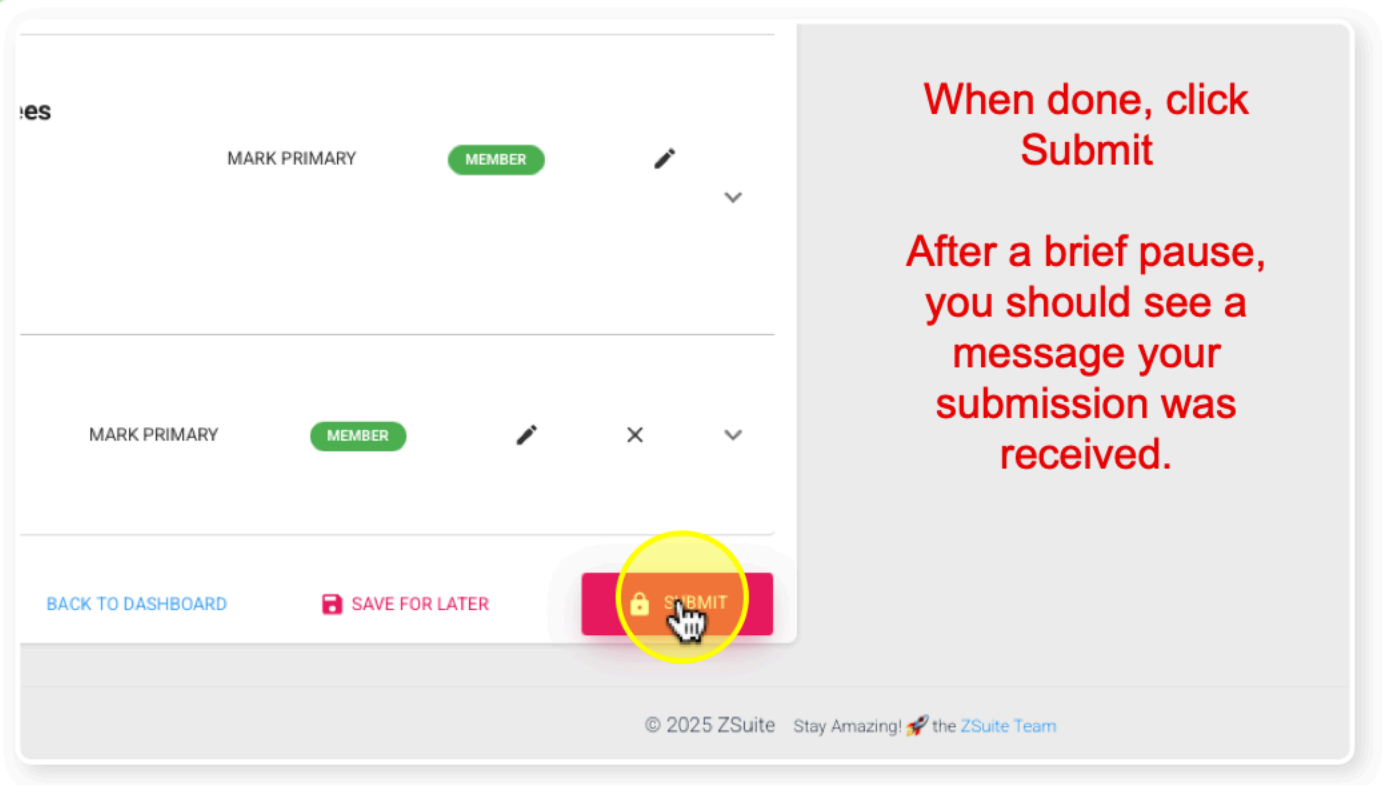

- 10 Click on "OK" and return to the Dashboard to reenroll other members.

